

* incl. 20 [-5; +30] mm pull out

3D model is available on request or www.hyva.com

| Specifications | | Max. pump flow | | Tipping time | |
|---|---------|-------------------------------------|-----------|-------------------------------------|--------|
| Max. working pressure | 250 bar | With KO ¹ | 151 L/min | With KO ¹ | 18 sec |
| Weight | 221 kg | Without KO ¹ | 106 L/min | Without KO ¹ | 26 sec |
| Working volume | 46 L | With KO ¹ below -20°C | 106 L/min | With KO ¹ below -20°C | 26 sec |
| Total volume | 51 L | Without KO ¹ below -20°C | 74 L/min | Without KO ¹ below -20°C | 37 sec |
| Max. cyl. load (start tipping) | 220 kN | | | Allowable lowering time | 15 sec |
| Max. cyl. load (end of stroke) ² | 115 kN | | | | |
| Max. cyl. load (end of stroke) ³ | 134 kN | | | | |

Technical notes

- This cylinder is a lifting device only.
- It should not be used as a structural member and should not be subjected to side loads.
- Tipping valve must have a pressure relief at the cylinder port set not higher than max. working pressure.
- Verify max. cyl. load.
- Working temperature range is between -40°C and +80°C.
- Max. duration of extension is 0.5 hours (excluded hard chromed stages).
- Cylinder is painted black (RAL9005) with a min. thickness conforming to the 480 hours neutral salt spray test as per ISO 9227.
- ¹ Hyva knock-off.
- ² Unsubstantial unloading (sticky load).
- ³ Substantial unloading.

Related documentation

- Bracket options: 015BRA10 & 015BRA12
- Mounting instructions: CYL-0030
- Oil specifications: OIL-0011
- Spec sheet explanation: CYL-0041

Configuration

| Extension | 1 | 2 | 3 | 4 | 5 | 6 | 7 | Total |
|-------------------------|------|------|------|------|---|---|---|-------|
| Effective diameter [mm] | 137 | 118 | 99 | 80 | | | | 4845 |
| Stroke* [mm] | 1190 | 1215 | 1220 | 1220 | | | | |

Tipping weight

For detailed tipping calculations please refer to: <https://tipper.hyva.com>

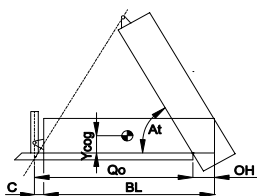

- BL body length
- OH rear overhang
- Ycog vert. pos. centre of gravity
- Qo pivot length
- C bracket length
- At tipping angle

| BL [mm] | 6400 | 6150 | 5900 | | | | | | | |
|-----------|------|------|------|-----|-----|-----|----|----|----|----|
| OH [mm] | 500 | 800 | 500 | 800 | 500 | 800 | | | | |
| At [°] | 45 | 47 | 50 | 47 | 50 | 52 | | | | |
| Ycog [mm] | 600 | 35 | 39 | 44 | 36 | 41 | 47 | 38 | 43 | 50 |
| | 900 | 38 | 43 | 50 | 40 | 45 | 54 | 42 | 48 | |
| | 1200 | 42 | 48 | | 44 | | 46 | | | |

Tipping weight [ton] at maximum pressure of 250 bar for a vertically mounted cylinder and C is 229 mm

| Pos. | Part no. | Description | Qty. |
|------|-----------|---------------------------------------|------|
| C01 | 71839040 | DUST COVER FC LOW 15-244 | 1 |
| C02 | 71736126 | COVER 242-0535 PIN60 A340 SPH LOCK | 1 |
| C03 | 01702956K | WASHER M48 DIN 125B ZP | 1 |
| C04 | 01702907K | TOPNUT NYLOC M48x3 DIN 985 ZP | 1 |
| C05 | 01791941 | O-RING COVER D.242 | 1 |
| C06 | 15014550K | BOLT HSHC M12X30X1.75 Q8.8 DIN 912 ZP | 1 |
| P01 | 70442441 | PISTON MN3 S 080-1445-HD-HC | 1 |
| P02 | 70207080K | SLIDER MN 080 (2 x 1/2) A35 | 1 |
| P03 | 70216080K | OUTER STOPRING MN 080 A22 | 2 |
| P04 | 70230080 | BOTTOM PLATE PISTON MN 080 MK2 HD | 1 |
| P05 | 01745030K | CIRCLIP 67 DIN 472 (71.5x2.5) | 1 |
| P06 | 70260210K | O-RING PISTON BOTTOM 080 | 1 |
| P07 | 70232305 | PISTON HEAD MN3 080 | 1 |
| P08 | 70260110K | O-RING 63.09 X 3.53 MM | 1 |

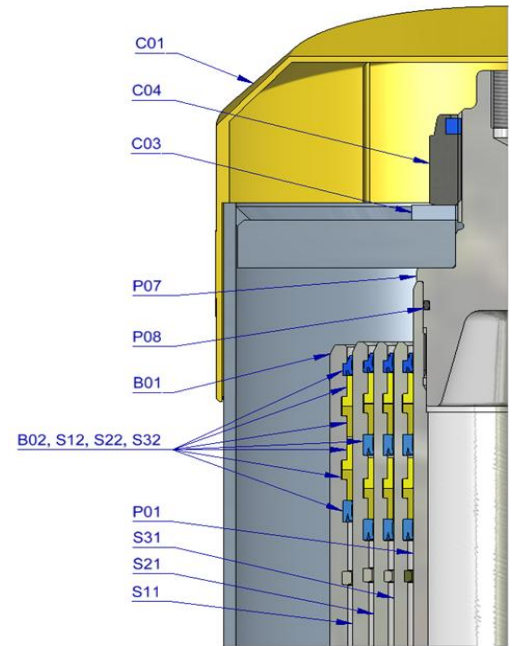

| | | | |
|-----|-----------|-----------------------------|---|
| S31 | 70673440 | STAGE MN2 099-1440-HD | 1 |
| S32 | 70202099K | PACKSET MN 099 TANDEM SEAL | 1 |
| S33 | 70207099K | SLIDER MN 099 (2 x 1/2) A35 | 1 |
| S34 | 70216099K | OUTER STOPRING MN 099 A22 | 2 |
| S35 | 70217099K | LIFTRING MN 099 A22 | 1 |

| | | | |
|-----|-----------|-----------------------------|---|
| S21 | 70674440 | STAGE MN2 118-1440-HD | 1 |
| S22 | 70202118K | PACKSET MN 118 TANDEM SEAL | 1 |
| S23 | 70207118K | SLIDER MN 118 (2 x 1/2) A35 | 1 |
| S24 | 70216118K | OUTER STOPRING MN 118 A22 | 2 |
| S25 | 70217118K | LIFTRING MN 118 A22 | 1 |

| | | | |
|-----|-----------|----------------------------|---|
| S11 | 70675440 | STAGE MN2 137-1440-HD | 1 |
| S12 | 70202137K | PACKSET MN 137 TANDEM SEAL | 1 |
| S13 | 70207137K | SLIDER MN 137 A35 | 1 |
| S14 | 70216137K | OUTER STOPRING MN 137 A22 | 1 |
| S15 | 70217137K | LIFTRING MN 137 A22 | 1 |

| | | | |
|-----|-----------|-------------------------------------|---|
| B01 | 70396444 | BASE MN2 157-1479-4/4BSAE-290-HD-TS | 1 |
| B02 | 70202157K | PACKSET MN 157 TANDEM SEAL | 1 |
| B03 | 70225355 | BOTTOM PLATE MN2 157 | 1 |
| B04 | 70270157K | SEAL BOTTOM PLATE MN 157 | 1 |
| B05 | 70220157 | LOCKING PLATE MN 157 | 3 |
| B06 | 01732055K | BOLT HEX M8X20X1.25 SET 6 PCS | 1 |
| B07 | 01732559K | WASHER SPRING M8 SET 6 PCS | 1 |

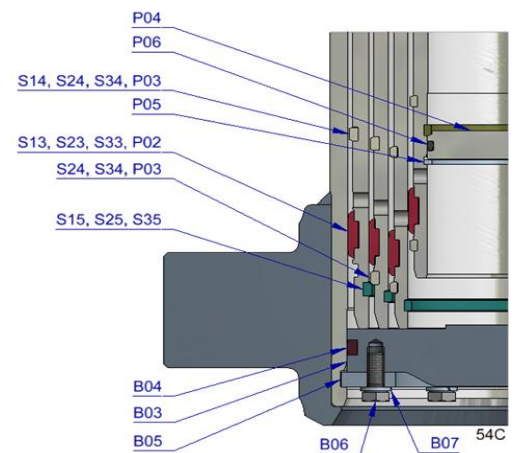
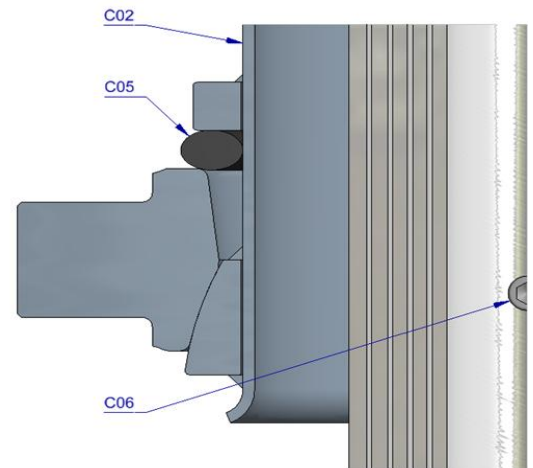

Seal kit complete

| | |
|-----------|--|
| 71907541K | Consists of all packsets with packset grease and O-rings |
|-----------|--|

Notes

The inner stopring and piston bottom are pre-mounted on spare bases, stage and pistons. Therefore, when ordering new tubes, it is not required to order these parts separately.

For repair instructions see: CYL-0040. Serial no. is located on type plate and near type plate support.