

For direct mounting on

- TNK: Hyva tank mounting plate

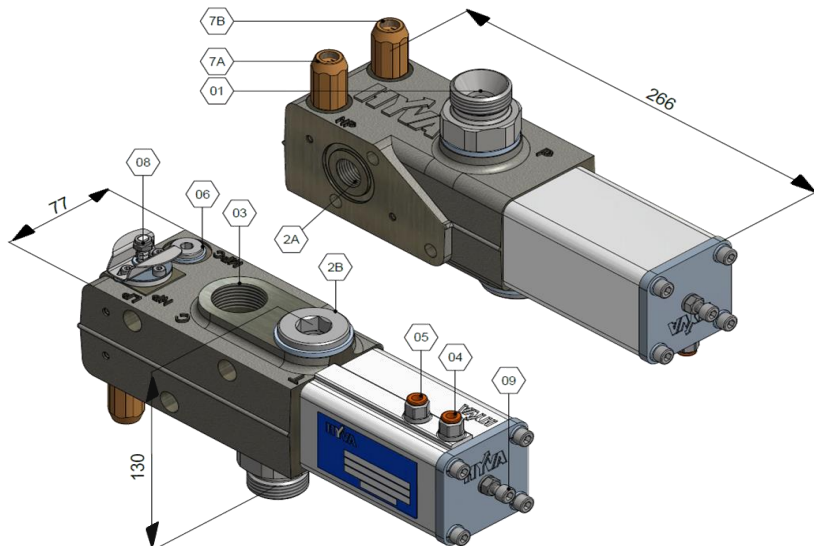

3D model is available on request

- 1 P Pump connection
- 2A T1 Tank connection
- 2B T2 Alternative tank connection
- 3 C Cylinder connection
- 4 Pneumatic connection (Tip) 6 mm
- 5 Pneumatic connection (Lower) 6 mm
- 6 MPC Measure Pressure Cylinder (Pressure gauge point)
- 7A High Pressure relief cartridge (HP)
- 7B Low Pressure relief cartridge (LP)
- 8 Manual pressure selector
- 9 Adjustment screw (int.hex. 5) (To adjust the lowering speed)

Types

Hydraulic connections	Pressure (bar)***		Part Number	Description	
	LP	HP			
P: G1" T1: G1/2" T2: G1" C: G1" MPC: G1/4"	110	220	14767150	TIP VALVE HT-TNK-2220-110-220-P1"	
		220	14767152	TIP VALVE HT-TNK-2220-150-220-P1"	
		150	250	14767155	TIP VALVE HT-TNK-2220-150-250-P1"
			280	14767158	TIP VALVE HT-TNK-2220-150-280-P1"
			350	14767165	TIP VALVE HT-TNK-2220-150-350-P1"
	170	220	14767172	TIP VALVE HT-TNK-2220-170-220-P1"	
		250	14767175	TIP VALVE HT-TNK-2220-170-250-P1"	
		280	14767178	TIP VALVE HT-TNK-2220-170-280-P1"	
		350	14767185	TIP VALVE HT-TNK-2220-170-350-P1"	
		190	220	14767192	TIP VALVE HT-TNK-2220-190-220-P1"
	250		14767195	TIP VALVE HT-TNK-2220-190-250-P1"	
	280		14767198	TIP VALVE HT-TNK-2220-190-280-P1"	
	350		14767200	TIP VALVE HT-TNK-2220-190-350-P1"	

Mounting kits	Kit number
Tank (TNK) *	14735168
Chassis**	14735208

* included with valve

** not included with valve

*** The user can select the maximum pressure setting by lifting and turning the selector towards HP or LP

Specifications

Type	3/3 pneumatic operated tipping valve with proportional lowering		
Max. pump flow	220	L/min	
Max. pressure	350	bar	
Pneumatic pilot pressure	6 - 12	bar	
Max. pressure on T-connections	10	bar	
Min. filtration	25	µm	
Viscosity range	min / max	12 / 100	mm ² /s (cSt)
Max. starting viscosity		1500	mm ² /s (cSt)
Temperature range	min / max	-40 / 80	°C
Mass	6,2	kg	

Δp - Q characteristic

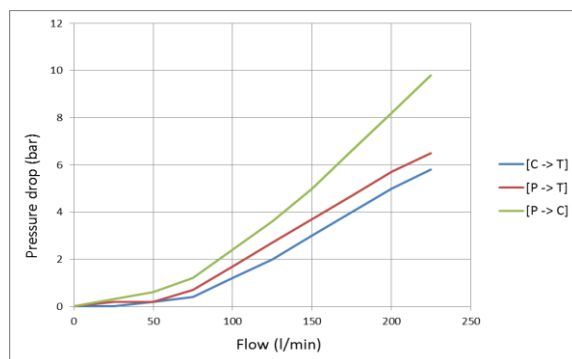

Technical notes

- Mount the valve according the mounting instructions
- Use the correct washers and adapters in the ports to prevent deformation of the housing. Do not use adapters with tapered threads
- To further prevent deformation of the valve housing, the mounting plate surface or block must be completely flat and smooth
- Do not weld to the valve
- Ideal air pressure for valve is 8 bar
- Make sure inlet air is dry and clean
- Painted black (RAL9005)

Related documentation

Mounting instructions: VAL-0022

OIL Specifications: OIL-0011

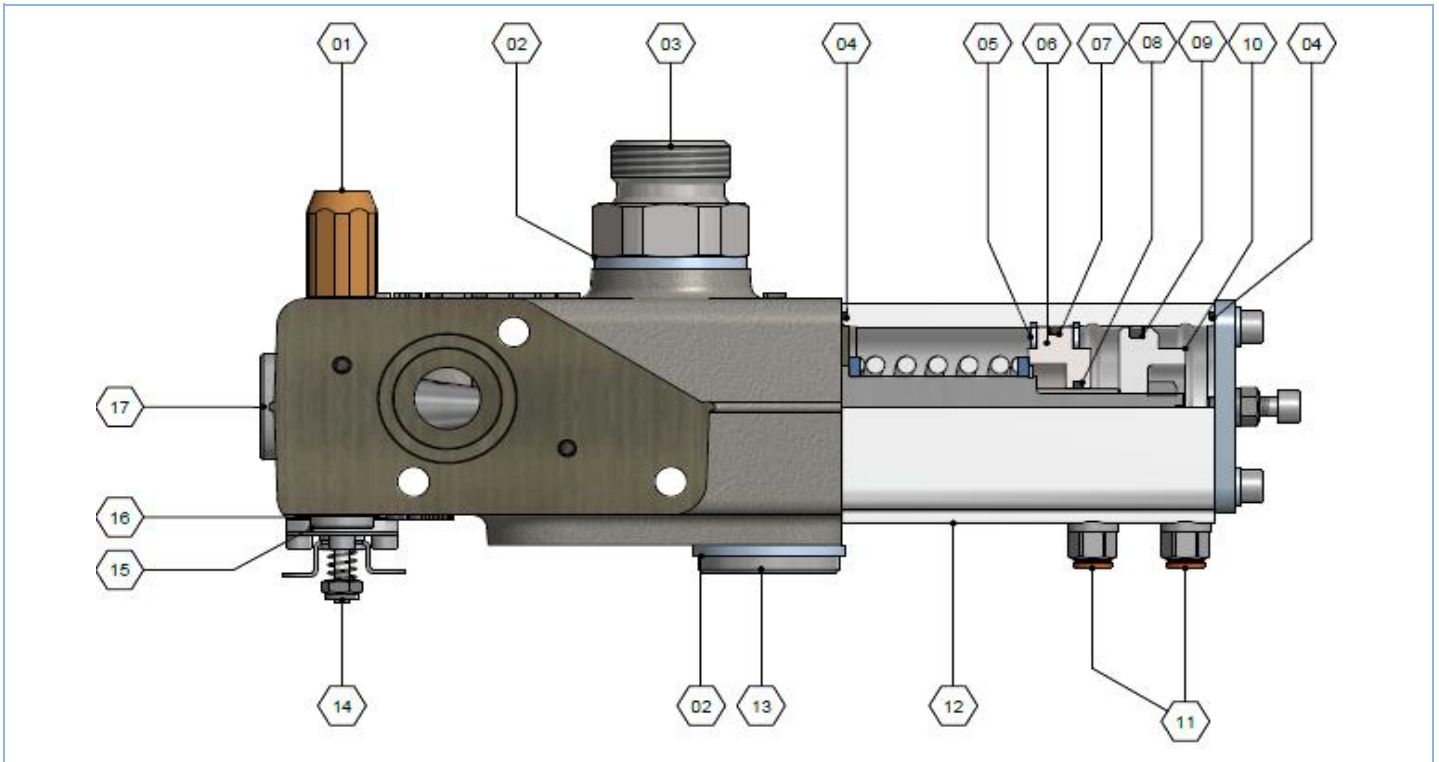

Spare Parts

No.	Part no.	Description	Qty.
1	14772	Pressure relief cartridge	2
	110	110 bar	
	150	150 bar	
	170	170 bar	
	190	190 bar	
	220	220 bar	
	250	250 bar	
	280	280 bar	
	350	350 bar	
2	01313848	Bonded seal 1"	1
3	14739975A	Non-return valve 1"	1
4	n.a; see repair kit	O-ring	2
5	n.a; see repair kit	Circlip	2
6	n.a; see repair kit	Closing plate	1
7	n.a; see repair kit	O-ring	1

No.	Part no.	Description	Qty.
8	n.a; see repair kit	Quadring	1
9	n.a; see repair kit	Quadring	1
10	n.a.	Piston air cylinder	1
11	14810517	Air coupling 6 mm	2
12	n.a; see repair kit	Aluminium head	1
13	n.a.	Plug 1"	1
15	n.a.	Plug 1/4"	1
16	01206813	Bonded seal 1/4"	1
17	n.a.	Plug M27	1

Repair kits

	14844010	Seal kit (contains pos. 4, 7, 8, 9)
	14845003	Air cylinder kit (contains pos. 5, 6, 7, 8, 12)
14	14845050	Pressure adjusting kit

Hydraulic symbol HT valve

